



# AAKCCB51系列說明書 AAKCCB51 INSTRUCTION MANUAL

**KWT** KIEN WELL TOY INDUSTRIAL CO., LTD  
www.kwcgun.com

台南市仁德區義林路168巷89號  
NO.89, LN. 168, YILIN RD.,  
RENDE DIST., TAINAN CITY  
71752, TAIWAN (R.O.C.)  
TEL : +886-6-2798175  
FAX : +886-6-2798176  
sales@kwcgun.com  
www.kwcgun.com

- SLOW DACK** 6mm AIR SOFT
- ENERGY** 1.8 joule MAX 136 m/s VELOCITY
- MATERIAL** 1100g METAL SLIDE
- LENGTH** 265mm
- MAGAZINE** AAK CCM51
- ADJUSTABLE HOP UP SYSTEM**
- SEMI AUTO**
- BBS CAPACITY** 20 rds. 6mm BB(0.24)

## 操作/OPERATION

### 操作說明 OPERATION

1. 取出彈匣  
RELEASE MAGAZINE.



1. 按下卡榫  
Press the button  
2. 取出彈匣  
Release the magazine.

▲注意: 請勿使彈匣直接掉落地面, 以防止變形或損壞。  
▲CAUTION: Magazine directly falling on ground could cause deform or damage on it. Please be aware.

2. CO2小鋼瓶的使用  
INSTALLING 12G CO2 CARTRIDGE  
逆時針轉出旋塞後, 置入小鋼瓶B, 再以順時針方向鎖緊旋塞A。當刺破鋼瓶出氣時, 請快速鎖緊。  
Turn the magazine cap out counter-clockwise and place CO2 cartridge B inside the magazine. Rapidly turn the screw A clockwise when piercing the cartridge in the magazine.

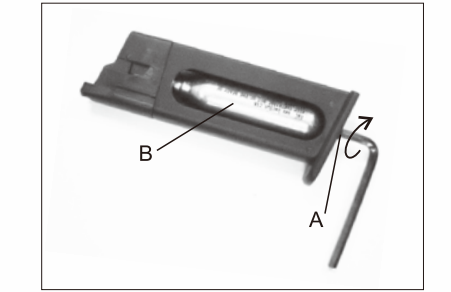

▲注意: 為維護彈匣使用壽命, 請儘可能不要殘留CO2氣體於彈匣內。  
▲CAUTION: To protect your magazine, please release all of the CO2 out of the magazine after every use.

### 3. 裝填BB彈 LOADING BB BULLET

將裝彈器套入彈匣上方, 然後再將BB彈放入透明管中, 以BB彈通條將BB彈塞入彈匣內。  
Put the quick loader on the top of magazine and load the BBs into the loader to load the BBs into the magazine.



4. 彈匣上膛  
INSERTING THE MAGAZINE  
將裝好B.B彈的彈匣插入槍身往上推入, 直到彈匣卡榫發出“卡嗒”為止。  
Insert fully loaded magazine in the airsoft until you hear the sound of “CLICK”.

5. B.B彈上膛  
CHAMBERING THE BB  
將上蓋往後拉到底, 放開上蓋則上蓋會自動回位, 同時亦將B.B彈送上膛完成射擊準備。  
Pulling the slide back. When the slide has been pulled completely back, release the slide without pushing and the BBs will be chambered.



▲注意: 拉動上蓋時, 請勿將手指扣住扳機, 以免發生不當射擊, 造成危險。  
▲CAUTION: The gun is now cocked and will fire when the trigger is pulled. Be careful not to fire accidentally.

### 6. 保險切換 SWITCH SAFETY

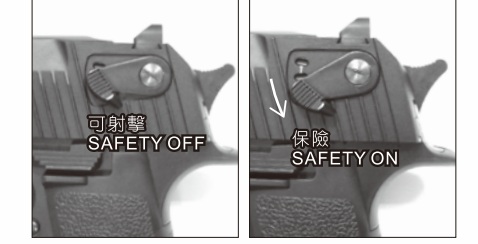

7. HOP UP調整  
HOP-UP ADJUSTMENT  
往左B.B彈上飄減弱, 往右B.B彈上飄增強。  
Turn right to make Hop-up bigger and turn left to make Hop-up smaller.



8. 射擊  
SHOOTING  
對準目標區後扣下扳機, 則B.B彈將被射擊出去。  
Aim the target and pull the trigger. Then the BB will be shot.



▲注意: B.B彈用完時, 上蓋會後定卡住。  
▲CAUTION: hold open function as real pistol.

## 故障/BREAK DOWN

### 拆解/ DIS-ASSEMBLY

1. 先退下彈匣。  
release the magazine

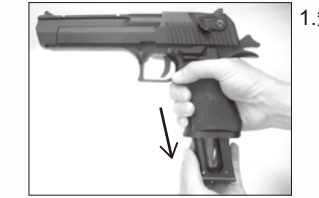

2. 按下槍管卡榫按鈕。  
Press and hold the barrel locker pin.



3. 同時另一邊槍管卡榫往下迴轉。  
Switch the barrel locker on the other side.



4. 將槍管往前拉出, 再往上拿出。  
Move barrel forward a little bit, then remove the barrel.



5. 滑蓋向前稍微強推即可分離。  
Push slide forward to release it.

6. 扣住扳機可以順勢將滑蓋退出或裝入。  
Holding trigger will help to remove/insert slide.



7. 槍枝拆解完成 Disassembly done.

### 故障的原因與排除 BREAK DOWN FAQ

\* 卡彈可能原因:  
the reason for BB jam :  
a. 裝彈排列不整齊。  
the BB in the magazine does not arrange very well.  
b. 不良B.B彈。  
bad quality BB  
c. 空擊發易造成零件損耗, 請避免此動作。  
Please avoid dry firing, for it could cause parts deformed or damage.

\* 排除: 將上蓋往後拉, 向下倒出即可。  
Solution: pull the slide back and pour the BB out from slide.



\* 射擊過程中偶而會發生, 在作動時上蓋突然停止無法作動, 而擊鐵回到原位, 彈匣中仍有足夠瓦斯和B.B彈。  
During the shooting process, sometimes the Slide and the Hammer stop unexpectedly.

## ! WARNING 警告

請務必嚴格遵守 使用說明指導書  
For your safety, please read this manual carefully before use.

此低動能遊戲用槍是針對喜愛射擊運動的消費者所開發。避免因使用方法不正確或改造所發生的故障或事故, 請務必詳讀說明書, 正確的操作享受愉快的射擊運動。

- 除了發射時外, 不要將手指頭掛在板機上。
- 選擇安全與適當標靶
- 在非使用期間, 請保持保險關閉且退彈的狀態, 就算在非使用狀態, 也要如同其已裝彈。
- 如任何的機械產品, 槍的保險也可能失效。即使在保險關閉的狀態下也請小心的操作此槍, 請勿將槍口對人。
- 千萬不要對堅硬或平坦表面、水面射擊, 以避免跳彈。
- 請妥善保管產品在未成io年孩童無法伸手取得的場所。
- 每次使用前後都應該檢查彈物, 假如擋彈物表面有磨損失效或是反彈時請停止使用。
- 請使用高品質BB彈, 請勿使用①口徑大於6mm②表面不平滑的③重複使用過的BB彈④非本說明書指名的發射物。
- 最高的使用及儲藏CO2小鋼瓶環境為50°C(122°F)以內, 高溫可能會造成CO2小鋼瓶過熱甚至爆炸。
- 檢查任何掉落之槍枝, 以確保未影響其功能。

**This airsoft is intended for recreational or training purposes. To prevent improper handling, modification or alteration causing malfunction or accident, please read the owner's manual carefully. Enjoy the pleasant shooting experience by proper operation.**

- Do not put your finger on the trigger except shooting.
- Please choose safe and proper target.
- Please always keep the airsoft on safe and unloaded when not using.
- Like all mechanical devices, an airsoft safety can fail. Always handle the airsoft safely even when the safety is “on safe”. Never point the airsoft at any people.
- Avoid ricochet. Never shoot at a hard or flat surface or at water.
- Keep the airsoft out of reach for small children.
- Your backstop should be inspected for wear before and after each use. Discontinue use of the backstop if surface shows signs of failure or ricochet.
- Only use high quality BB. Never use ①BB diameter larger than 6mm②BB with unsmoothed surface③reused BB that has been fired④incorrect projectiles not design for this airsoft
- Do not expose CO2 cartridges to heat or store them at temperatures above 50°C(122°F). CO2 cartridges may over heat or explode at temperatures above 50°C(122°F).
- Check any gun that has been dropped to ensure that its function has not been affected.



\* 排除: 此時並非故障, 只需重新上膛便可繼續使用。  
SOLUTION: This is not the failure. Just reload it and operate again.

### 保養及維護 MAINTENANCE GUIDE

當射擊約2000發時, 建議你如圖所示, 以矽油脂適量在上蓋與本體滑動接觸面及擊鐵、撞針作動處潤滑, 以利滑動。  
After every 2,000 BB shots, lubricating the Firing pin and Track as pictures below is recommended.

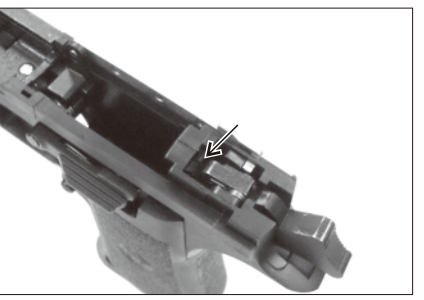
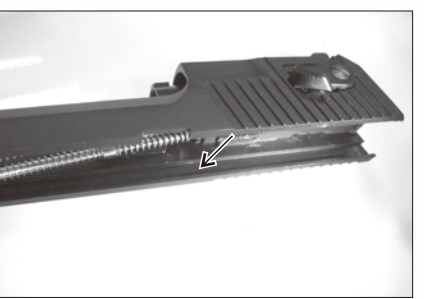

# WARNING 警告

★使用低動能遊戲用槍前，請務必戴上保護眼鏡或面罩。  
★Always wear eye protection when using airsoft.

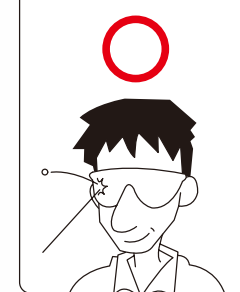

★不可攜帶低動能遊戲用槍在公共場所行走，請務必裝在袋子或盒子內。  
★Always transport an airsoft in a locked carrying case. Make sure it is unloaded and on safe.

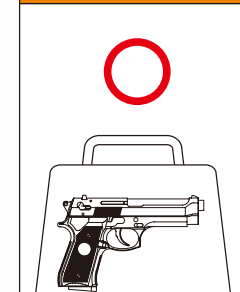

★使用低動能遊戲用槍前，請務必詳讀說明書內容。  
★Read the owner's manual before using the airsoft.

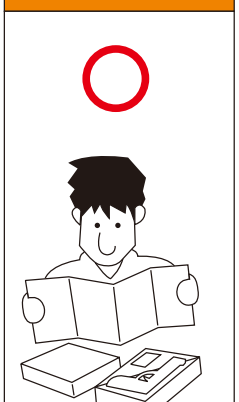

★請不要由槍口向內探視。  
★To Avoid accidental discharge, do not look directly into the barrel.

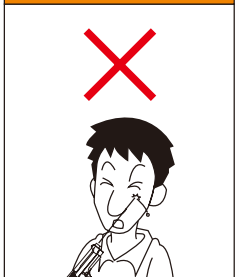

★請不要在公開場合使用低動能遊戲用槍，也請不要拿低動能遊戲用槍對準人或動物。  
★Never brandish or aiming this airsoft at any people or domestic animals. Brandish this airsoft in public is dangerous and may be a crime.

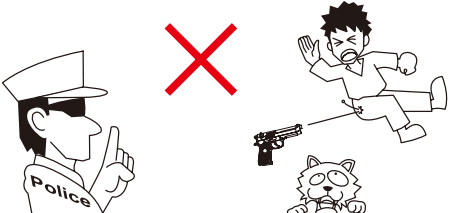

★請確認後再發射BB彈方向，附近無人或動物存在。  
★Always be aware of your surrounding before and during shooting and select a safe area for target practice.

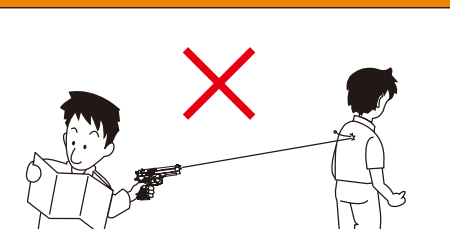

★不可任意改造或加工低動能遊戲用槍，私自改造加工會造成產品損壞、保固失效，導致使用上不安全，甚至觸法送辦。  
★Disassemble, modify, or alter of your airsoft may cause malfunction, void your warranty and may make it unsafe to use.

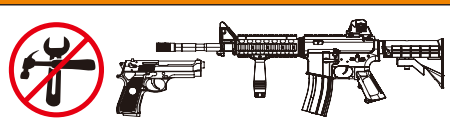

Do not display this pistol in public—it may confuse people and may be a crime. 請不要忘了，雖然自己知道這只是玩具，但不知道的人，會以為這是真槍。

## AAKCCB51 系列零件表

| 編號        | 零件名稱      | 編號        | 零件名稱     |
|-----------|-----------|-----------|----------|
| P01       | 本體        | KCB51-Z51 | 彈匣本體     |
| P04       | 槍柄        | KCB51-Z52 | 彈匣底座     |
| KMB15-P10 | 心棒迫緊      | Z51       | 保險連桿配件   |
| P14       | 保險滑粒      | Z52       | 撞針本體     |
| P15       | 彈匣上部      | Z53       | 擊鐵卡榫     |
| P16       | 後準星       | Z54       | 氣閥撞針     |
| P17       | 槍管接筒      |           |          |
| P18       | HOP-UP調整圈 | S03       | 彈匣卡榫壓簧   |
| P19       | 彈匣滑粒      | S04       | 扳機扭簧     |
| P20       | 氣缸        | S08       | 導管卡榫按鈕壓簧 |
| P22       | 氣缸前罩(連發)  | S13       | 撞針扭簧     |
| P27       | 槍管接筒前部    | S14       | 撞針定位件扭簧  |
| P23       | 滑套射嘴      | S20       | 心棒壓簧     |
| P35       | 氣流控制件     | S18       | 連發擊鐵卡榫扭簧 |
| P53       | 前準星       | S19       | 連發卡榫扭簧   |
|           |           | S20       | 連發撞針本體扭簧 |
| A02       | 鋁合金上蓋     | S23       | 保險壓簧     |
| A03       | 鋁合金外槍管    | S31       | 擊鐵扭簧     |
|           |           | S32       | 彈匣壓簧     |
| Z05       | 扳機        | S33       | 上蓋回位壓簧前  |
| Z09       | 導管定位件     | S41       | 槍管扣環     |
| Z11       | 保險連桿      | S42       | 射嘴回位壓簧   |
| Z12       | 上蓋止動片     | S43       | 上蓋止動片扭簧  |
| Z13       | 彈匣卡榫(左)   |           |          |
| Z14       | 彈匣卡榫(右)   | DE-301    | 回位壓簧配件   |
| Z18       | 氣缸後罩      | DE-606B   | 上蓋回位壓簧後  |
| Z19       | 回位壓簧導件    | B01       | 保險螺絲     |
| Z22       | 擊鐵        | KG51-B02  | 扳機軸套     |
| Z25       | 擊鐵箱(左)    | KW-B02    | 氣瓶頂針     |
| Z26       | 擊鐵箱(右)    | B03       | 槍管       |
| Z27       | 槍管導管卡榫    | B06       | 擊鐵軸套     |
| Z28       | 導管卡榫按鈕    | B07       | 氣閥撞針軸套   |
| Z29       | 止動片推桿     | B08       | 撞針定位片軸   |
| Z35       | 保險(左)     | B13       | 氣缸配件     |
| Z36       | 保險(右)     | B31       | 氣閥本體     |
| Z50       | 扳機連桿      | B32       | 心棒蓋      |

| 編號       | 零件名稱              | 編號       | 零件名稱              |
|----------|-------------------|----------|-------------------|
| KC51-B33 | 心棒                | KC51-B33 | 軸(彈匣上部用)          |
| KC51-B33 | 軸(彈匣底座)           | B37      | 軸(彈匣上部用)          |
| B003     | 鋼珠                | B003     | 鋼珠                |
| B215     | 氣瓶頂針迫緊            | B215     | 氣瓶頂針迫緊            |
| E06      | 軸(擊鐵)             | E06      | 軸(擊鐵)             |
| E10      | 軸(本體)             | E10      | 軸(本體)             |
| EA040    | Φ3.0X6束鉚螺絲        | EA040    | Φ3.0X6束鉚螺絲        |
| EA050    | Φ3.0X20黑熱螺絲       | EA050    | Φ3.0X20黑熱螺絲       |
| EA053    | Φ3.2X5束鉚螺絲        | EA053    | Φ3.2X5束鉚螺絲        |
| EA065    | Φ3.2X6黑螺絲         | EA065    | Φ3.2X6黑螺絲         |
| EA079    | Φ3.3X15黑螺絲        | EA079    | Φ3.3X15黑螺絲        |
| EA106    | 止付螺絲3.0X4黑        | EA106    | 止付螺絲3.0X4黑        |
| EA113    | 止付螺絲M10X10黑       | EA113    | 止付螺絲M10X10黑       |
| EB002    | 彈簧墊圈              | EB002    | 彈簧墊圈              |
| EC014    | 彈簧銷               | EC014    | 彈簧銷               |
| ED004    | E型扣環(E2.5/鍍銀)     | ED004    | E型扣環(E2.5/鍍銀)     |
| EF001    | KG-42X六角扳手        | EF001    | KG-42X六角扳手        |
| F01      | 回位導桿              | F01      | 回位導桿              |
| F03      | 上蓋定位件             | F03      | 上蓋定位件             |
| F04      | 止動片軸              | F04      | 止動片軸              |
| F12      | 扳機連桿彈片            | F12      | 扳機連桿彈片            |
| F52      | 撞針配件              | F52      | 撞針配件              |
| F53      | 連發擊鐵卡榫            | F53      | 連發擊鐵卡榫            |
| F10N     | 撞針定位片             | F10N     | 撞針定位片             |
| F51B     | 撞針軸               | F51B     | 撞針軸               |
| R05      | 氣嘴迫緊              | R05      | 氣嘴迫緊              |
| R07      | 子彈迫緊              | R07      | 子彈迫緊              |
| G036     | O型環2*11           | G036     | O型環2*11           |
| G015     | O型環S-4 NBR        | G015     | O型環S-4 NBR        |
| G016     | O型環S-4 PU         | G016     | O型環S-4 PU         |
| G033     | O型環P-9            | G033     | O型環P-9            |
| G010     | O形環1X8            | G010     | O形環1X8            |
| G019     | 1.5X4.5 O型環(PU90) | G019     | 1.5X4.5 O型環(PU90) |
| U12      | 裝彈器組件             | U12      | 裝彈器組件             |

## AAKCCB51 SERIES PARTS LIST

| NO.       | UNIT                   | NO.       | UNIT                          |
|-----------|------------------------|-----------|-------------------------------|
| P01       | FRAME                  | KCB51-Z51 | MAGAZINE FRAME                |
| P04       | GRIP                   | KCB51-Z52 | MAGAZINE BASE                 |
| KMB15-P10 | VALVE PACKING          | Z51       | SAFETY LINK ACCESSORY         |
| P14       | SAFETY FOLLOWER        | Z52       | FIRING PIN                    |
| P15       | MAGAZINE RIB           | Z53       | HAMMER CATCH                  |
| P16       | REAR SIGHT             | Z54       | VALVE HAMMER                  |
| P17       | BARREL CONNECTOR       |           |                               |
| P18       | HOP-UP                 | S03       | MAGAZINE CATCH SPRING         |
| P19       | MAGAZINE FOLLOWER      | S04       | TRIGGER SPRING                |
| P20       | CYLINDER               | S08       | BARREL CATCH BUTTON SPRING    |
| P22       | BOLT GUIDE             | S13       | FIRING PIN SPRING             |
| P27       | FRONT BARREL CONNECTOR | S14       | FIRING PIN LOCATOR SPRING     |
| P23       | LOADING NOZZLE         | S20       | VALVE SPRING                  |
| P35       | FLOATING VALVE         | S18       | FULL AUTO HAMMER CATCH SPRING |
| P53       | FRONT SIGHT            | S19       | FULL AUTO CATCH SPRING        |
|           |                        | S20       | FULL AUTO FIRING PIN SPRING   |
| A02       | ALUMINUM SLIDE         | S23       | SAFETY SPRING                 |
| A03       | ALUMINUM OUTER BARREL  | S31       | HAMMER SPRING                 |
|           |                        | S32       | MAGAZINE SPRING               |
| Z05       | TRIGGER                | S33       | RECOIL SPRING FRONT           |
| Z09       | BARREL LOCATOR         | S41       | BARREL E RING                 |
| Z11       | SAFETY LINK            | S42       | LOADING NOZZLE RECOIL SPRING  |
| Z12       | SLIDE STOPPER          | S43       | SLIDE STOPPER SPRING          |
| Z13       | MAGAZINE CATCH (L)     |           |                               |
| Z14       | MAGAZINE CATCH (R)     | DE-301    | RECOIL SPRING ACCESSORY       |
| Z18       | CYLINDER BACK COVER    | DE-606B   | RECOIL SPRING REAR            |
| Z19       | RECOIL SPRING PLATE    | B01       | SAFETY SCREW                  |
| Z22       | HAMMER                 | KG51-B02  | TRIGGER SLEEVE                |
| Z25       | CHASSIS (L)            | KW-B02    | PUNCTURE VALVE                |
| Z26       | CHASSIS (R)            | B03       | BARREL                        |
| Z27       | BARREL CATCH           | B06       | HAMMER SLEEVE                 |
| Z28       | BARREL CATCH BUTTON    | B07       | VALVE FIRING PIN SLEEVE       |
| Z29       | SLIDE STOPPER LEVER    | B08       | FIRING PIN LOCATOR AXLE       |
| Z35       | SAFETY (L)             | B13       | CYLINDER SLEEVE               |
| Z36       | SAFETY (R)             | B31       | VALVE FRAME                   |
| Z50       | TRIGGER BAR            | B32       | VALVE CAP                     |

## AAKCCB51 系列零件分解圖 AAKCCB51 SERIES EXPLORED VIEW

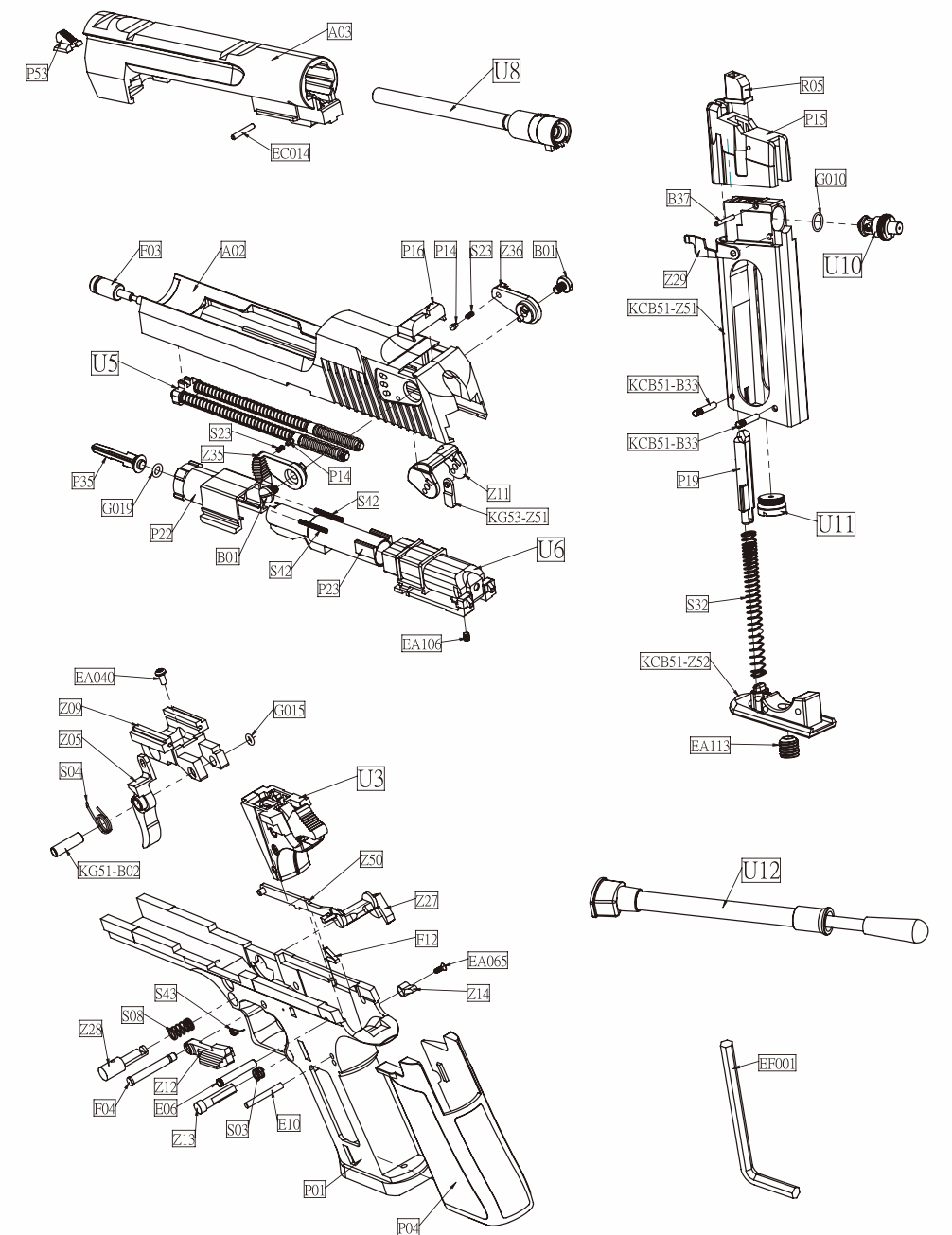

## AAKCCB51 系列零件分解圖 AAKCCB51 SERIES EXPLORED VIEW

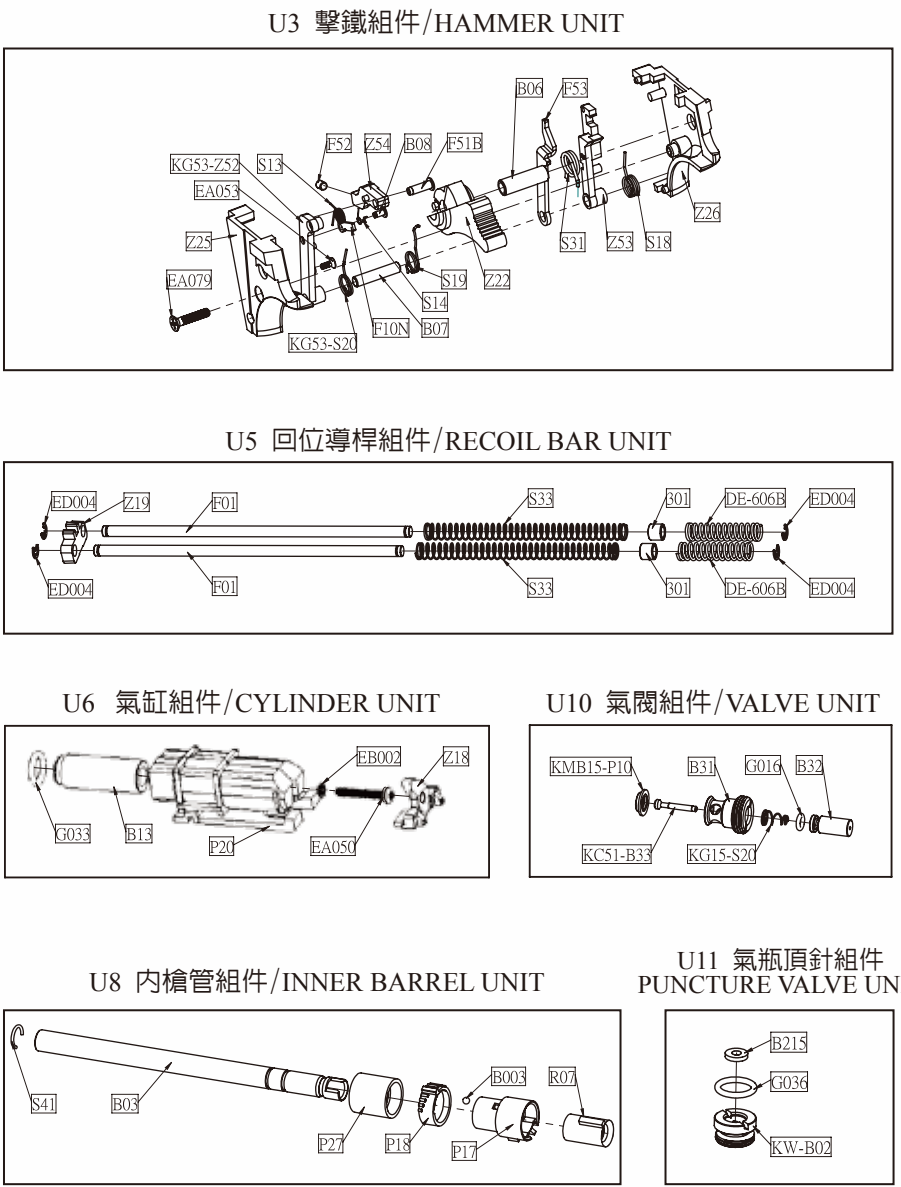

※零件有時為了改良而不經預告變更。  
Spare parts may be modified for quality improvement  
And such modification may be without advance notice.